

ITEM NO.			
1	NGP	5075	ADHESIVE GASKETING
2	NGP	5060	ADHESIVE GASKETING
3	NGP	335S X STC2	AUTOMATIC DOOR BOTTOM
4	NGP	60FP	ACOUSTICAL FOAM PAD

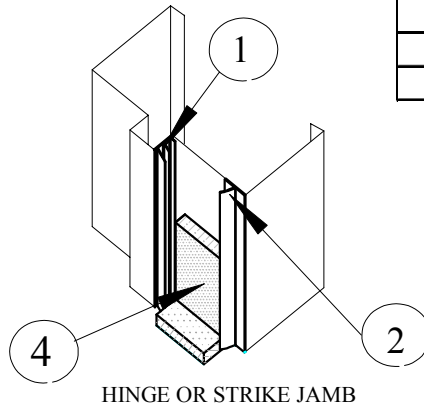

NOTE: ACOUSTICAL FOAM PADS ARE TO BE INSTALLED ON BOTH JAMB LEGS WHERE THEY MEET THE FLOOR OR THRESHOLD BENT AND ADHERED TO BOTH AS SHOWN.

NOTES;

1. THIS DRAWING REFERS TO SEAL ORIENTATION ONLY.
2. REFER TO SEAL MANUFACTURERS INSTALLATION INSTRUCTIONS FOR APPROPRIATE INSTALLATION TECHNIQUE AS DETERMINED PER SEAL BEING USED.
3. DRAWING NOT TO SCALE.
4. OSHKOSH DOOR COMPANY RESERVES THE RIGHT TO CHANGE DESIGN AND / OR DETAILS OF ITS PRODUCTS WITHOUT NOTICE.

**OSHKOSH**  
Door Company

FOR MORE INFORMATION  
CALL 920-233-6161

DETAIL DRAWING SHEET

Gasket Set 29

SHEET OF