

ITEM NO.	DESCRIPTION SEAL SET NO. 11		
1	PEMKO	S773	2 SETS ADHESIVE GASKETING
2	PEMKO	S44	ADHESIVE GASKETING
3	PEMKO	151	FLAT SADDLE

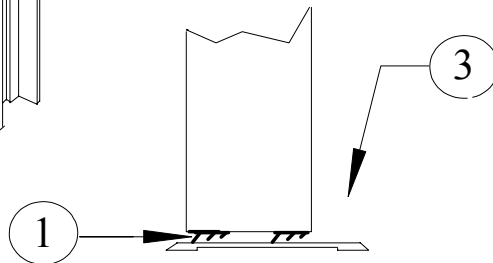

NOTES;

1. THIS DRAWING REFERS TO SEAL ORIENTATION ONLY.
2. REFER TO SEAL MANUFACTURERS INSTALLATION INSTRUCTIONS FOR APPROPRIATE INSTALLATION TECHNIQUE AS DETERMINED PER SEAL BEING USED.
3. DRAWING NOT TO SCALE.
4. OSHKOSH DOOR COMPANY RESERVES THE RIGHT TO CHANGE DESIGN AND / OR DETAILS OF ITS PRODUCTS WITHOUT NOTICE.

**OSHKOSH**  
Door Company

FOR MORE INFORMATION  
CALL 920-233-6161

**DETAIL DRAWING SHEET**

Gasket Set 11

Date: 5/2015

**DD611**

SHEET OF